

The special touches

We've thought of them:

- Generous walk-in closets
- Walk-in showers with seat
- Grab bars in the bathrooms
- Patio off the dining room
- Kitchen and dining room facilities
- Bay windows
- Grocery and pharmacy delivery
- Blinds as window treatments
- Guest suite
- Library
- Electrical outlets placed higher for easy reach
- Maintenance of building and grounds
- Refuse removal
- Professional management
- Main office is open Monday – Friday
- Conveniently connected to Traverse Care Center for transitional and long-term care services
- And much more!



\$ _____ One-Bedroom (517 sq. ft.)

\$ _____ One-Bedroom Deluxe (603 sq. ft.)

\$ _____ Two-Bedroom (739 sq. ft.)

\$ _____ Garage Fee (Optional)

\$ _____ Additional Person (Per Month)

\$ _____ Air Conditioning (Seasonal Fee)

For more information or to make a referral:

Contact Michele Listrom at
mlistrom@frazeeccarecenter.com

305 Seventh Street
Wheaton, MN 56296
Phone: 320-563-8124

 *Connect with us on Facebook*



traversecarecenter.com/prairieviewplace



Independent Senior Living



Your complete
Senior Living
Community.

Prairieview Place is designed especially for you...

At Prairieview place, you'll find a welcoming atmosphere elevated by care, ease and relaxation. Our senior living community is thoughtfully designed with you in-mind—in your private apartment and in the distinctive common areas you'll enjoy with your neighbors. Here, you'll treasure quiet conversations, the fireplace on a snowy evening, a good movie, planned activities and social get-togethers. We've also included special amenities to help each individual achieve the highest possible level of good health and independence.

Delicious meals served in the main dining room will be a highlight of your day. Because nutrition plays a key role in your good health, one meal each day is included in your monthly fee, with additional meals available upon request. Your family and friends are always welcome to be your guests – you'll find that entertaining has never been easier!

You'll sincerely appreciate Prairieview Place's values-driven team as well as the housekeeping services that are included in your monthly rent. If needed, additional support is available to help you get your laundry and cleaning done efficiently.

At Prairieview Place, safety is a priority. In case of any emergency, a touch of the button on your state-of-the-art wireless transmitter will alert help immediately and provide your location. Prairieview Place is also equipped with building security, fire safety procedures, and a complete sprinkler system.



Prairieview Place is an independent senior living community that's home to 20 apartments and services for those age 55 and older. Located in Wheaton, Minnesota, our community is designed to provide tenants with a safe, comfortable and affordable lifestyle, while preserving their independence and privacy. When joining our community, you can choose from a one-bedroom, one-bedroom with den, two-bedroom, or a fully accessible model apartment.

Unit A • 517 sq. ft.

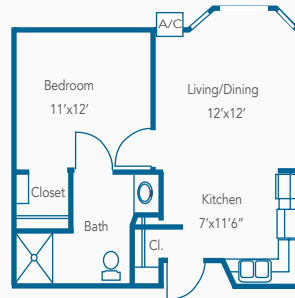

Unit B • 603 sq. ft.

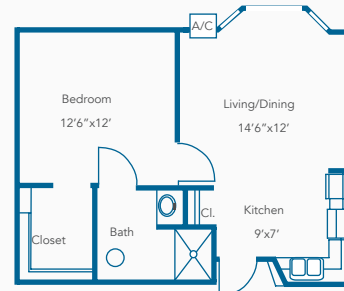

Unit C • 739 sq. ft.

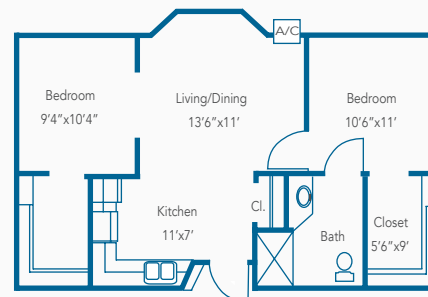

Amenities and Services

- NO entrance fee
- Major utilities paid
- Daily meal served at noon
- Weekly light housekeeping
- LifeLine medical alert wireless system
- Non-emergency scheduled transportation available
- Activities programming
- Exercise program
- Weekly religious services
- Access to special, planned events at Traverse Care Center
- Fully-equipped laundry facility
- Fireplace seating lounge
- Multi-purpose common room
- Barber and beauty shop available
- Centrally-located elevator
- Attached garages
- Off-street parking for you and your guests
- Security controlled entrance
- Sprinklers and alarms for fire safety
- Convenient, indoor mail service

