

The special touches

We've thought of them:

- Generous walk-in closets
- Walk-in showers with seat
- Grab bars in the bathrooms
- Patio off the dining room
- Kitchen and dining room facilities
- Bay windows
- Grocery and pharmacy delivery
- Blinds as window treatments
- Guest suite
- Library
- Electrical outlets placed higher for easy reach
- Maintenance of building and grounds
- Refuse removal
- Professional management
- Main office is open Monday – Friday
- Conveniently connected to Traverse Care Center for transitional and long-term care services
- And much more!



\$ _____ One-Bedroom (517 sq. ft.)

\$ _____ One-Bedroom Deluxe (603 sq. ft.)

\$ _____ Two-Bedroom (739 sq. ft.)

\$ _____ Garage Fee (Optional)

\$ _____ Additional Person (Per Month)

\$ _____ Air Conditioning (Seasonal Fee)

For more information or to make a referral:

Contact Mary Schmitz at
MSchmitz@traversecarecenter.com

305 Seventh Street
Wheaton, MN 56296
Phone: 320-563-8600

 [Connect with us on Facebook](#)



traversecarecenter.com/prairieviewplace



Independent Senior Living



Your complete
Senior Living
Community.

Prairieview Place is designed especially for you...

Offering you a caring atmosphere of ease and relaxation. We have considered your unique building design requirements – both in the apartments and in the distinctive common areas you'll enjoy with your neighbors. We've also included special amenities to help each individual achieve the highest possible level of good health and independent lifestyle. And, don't forget the quiet conversations, the fireplace on a snowy evening, a good movie, hobbies and all the social get-togethers.

Delicious meals served in the main dining room will be one of the highlights of your day. Because nutrition plays a key role in your good health, one main meal each day is included in your monthly fee, with additional meals available upon request. And, your family and friends are always welcome to be your guests – you'll find that entertaining has never been easier!

You'll also appreciate the manager and maintenance staff of Prairieview Place, as well as the housekeeping services that are included in the monthly rent. If needed, additional cleaning help and laundry services are available.

At Prairieview Place, safety is a primary consideration. So, in case of any emergency, the touch of a button on your state-of-the-art wireless transmitter will alert help immediately and provide your location. Prairieview Place also has building security, fire safety procedures, and a complete sprinkler system.



Prairieview Place is an independent senior living community, with services for those age 55 and older. These 20 units, located in Wheaton, Minnesota, are designed to provide tenants with a safe, comfortable and affordable lifestyle, while preserving their independence and privacy. You'll choose either a one-bedroom, one-bedroom with den, a two-bedroom or a model tailored to individuals with disabilities.

Unit A • 517 sq. ft.

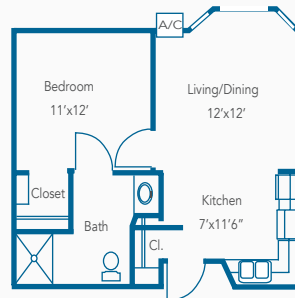

Unit B • 603 sq. ft.

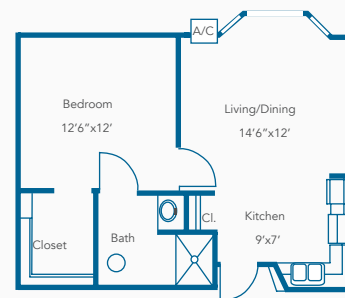

Unit C • 739 sq. ft.

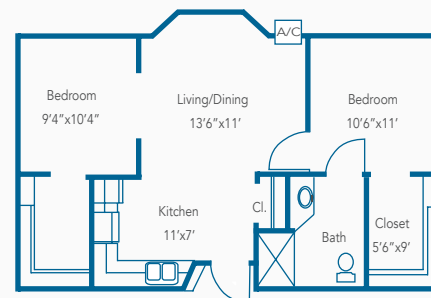

Amenities and Services

- NO entrance fee
- Major utilities paid
- Daily noon meal
- Weekly light housekeeping
- LifeLine medical alert wireless system
- Non-emergency scheduled transportation available
- Activities program
- Exercise program
- Weekly religious services
- Special and social events hosted at Traverse Care Center
- Fully-equipped laundry facility
- Fireplace seating lounge
- Multi-purpose room
- Barber/beauty shop available
- Centrally-located elevator
- Attached garages
- Off-street parking for you and your guests
- Security controlled entrance
- Sprinklers and alarms for fire safety
- Convenient, indoor mail service

